

01 MAIN STREET

LIVING

LONDON 0-0-01-001

TOTAL

TRANSFORMATION

# 01 Main Street

## Brief

### Existing Living Space

The design is for a living room in a 3-storey terraced house. The area is spacious but cold and lacking natural light. The living room is accessed via a door directly through a straight corridor from the main entrance and is sandwiched in between the kitchen and a rear garden extension. The use of the rear extension is yet to be defined but the resident intends to frequently host guests and provide a multifunctional space. The main living room needs to be cosy and feel warm when home alone but also welcoming to guests with a defined space for 1-1 coffee meetings at a small table. The space needs to remain flexible for potential change of use and needs in the near future.

#### Design requirements

- Small table with chairs in defined space
- Lighting solutions to address lack of natural light
- New furniture
- No heavy structural work but appetite for light superficial interventions
- Colourful scheme
- "Minimal" and "Clean" quality design
- Budget undefined

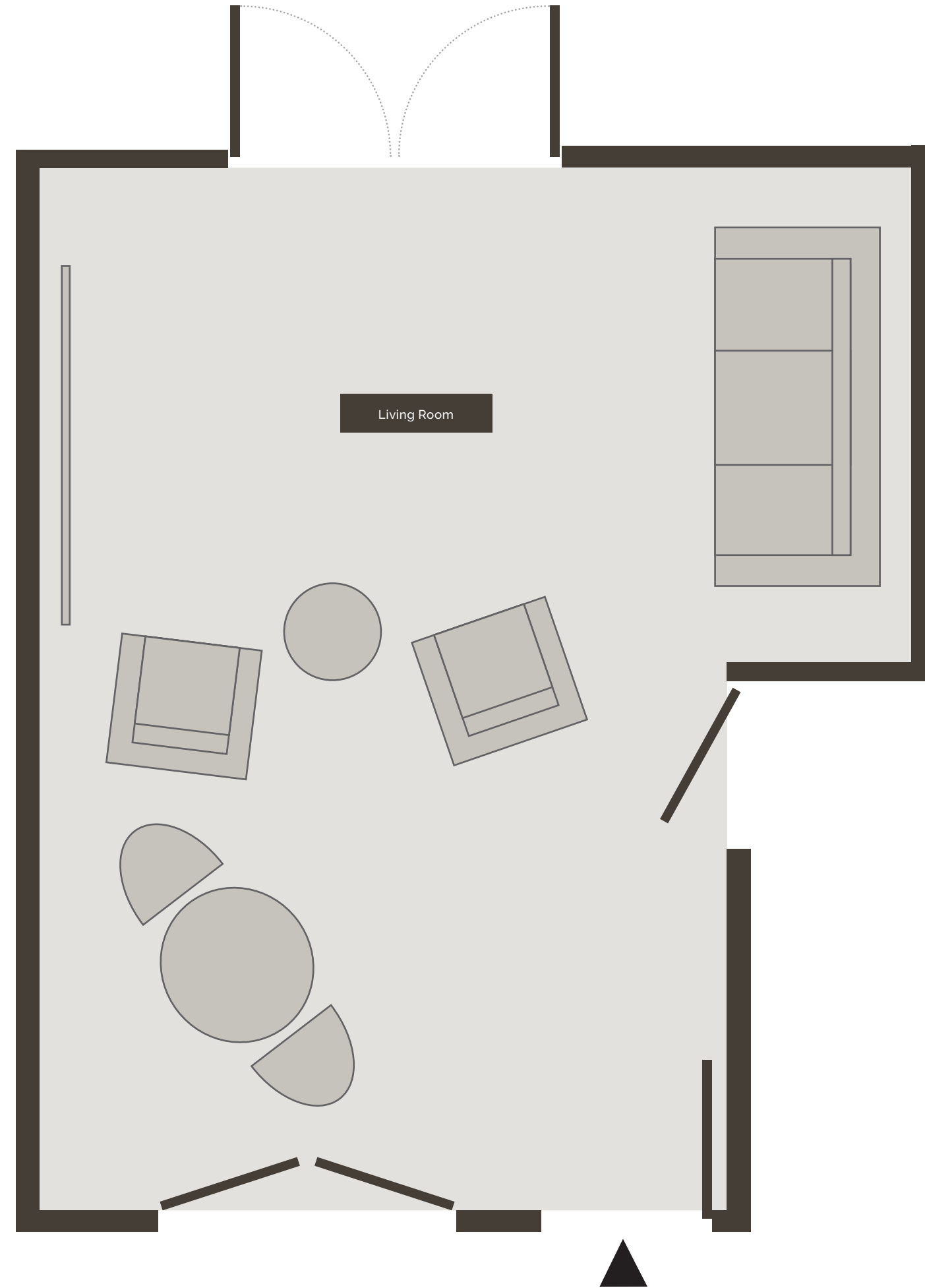

# 01 Main Street

## Brief

### Existing Living Space

The design is for a living room in a 3-storey terraced house. The area is spacious but cold and lacking natural light. The living room is accessed via a door directly through a straight corridor from the main entrance and is sandwiched in between the kitchen and a rear garden extension. The use of the rear extension is yet to be defined but the resident intends to frequently host guests and provide a multifunctional space. The main living room needs to be cosy and feel warm when home alone but also welcoming to guests with a defined space for 1-1 coffee meetings at a small table. The space needs to remain flexible for potential change of use and needs in the near future.

#### Design requirements

- Small table with chairs in defined space
- Lighting solutions to address lack of natural light
- New furniture
- No heavy structural work but appetite for light superficial interventions
- Colourful scheme
- "Minimal" and "Clean" quality design
- Budget undefined

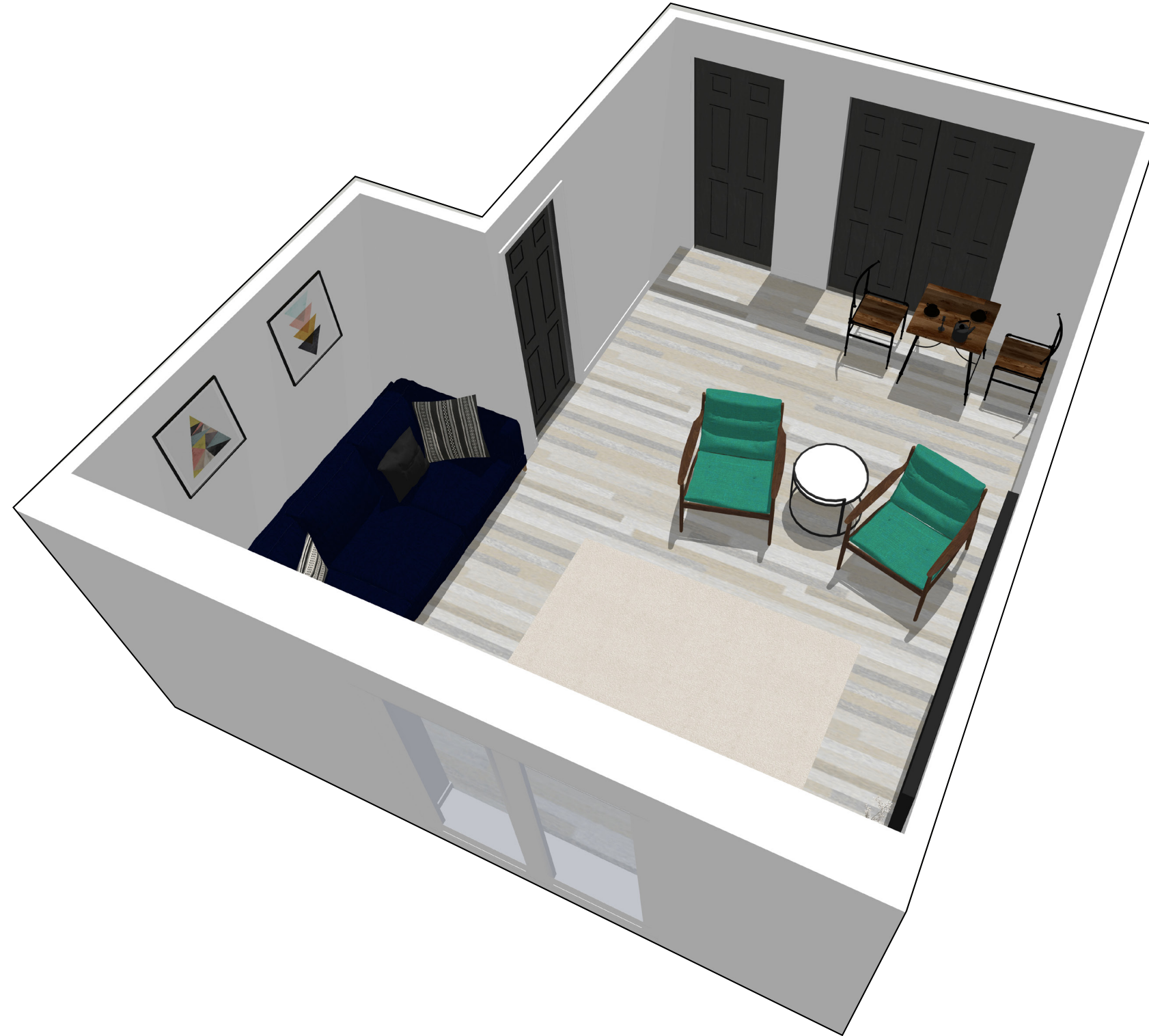

# Project Brief

## Living Space Room Revamp

- Barn style sliding door installation to kitchen
- Built out TV console for recessed TV and electric/faux fireplace
- Feature slat wood wall and dining area
- Additional sofa to define space
- Flexible, less permanent space
- Decorative shelving in corner behind sofa
- Formal dining/meeting area
- Replacement of door to extension

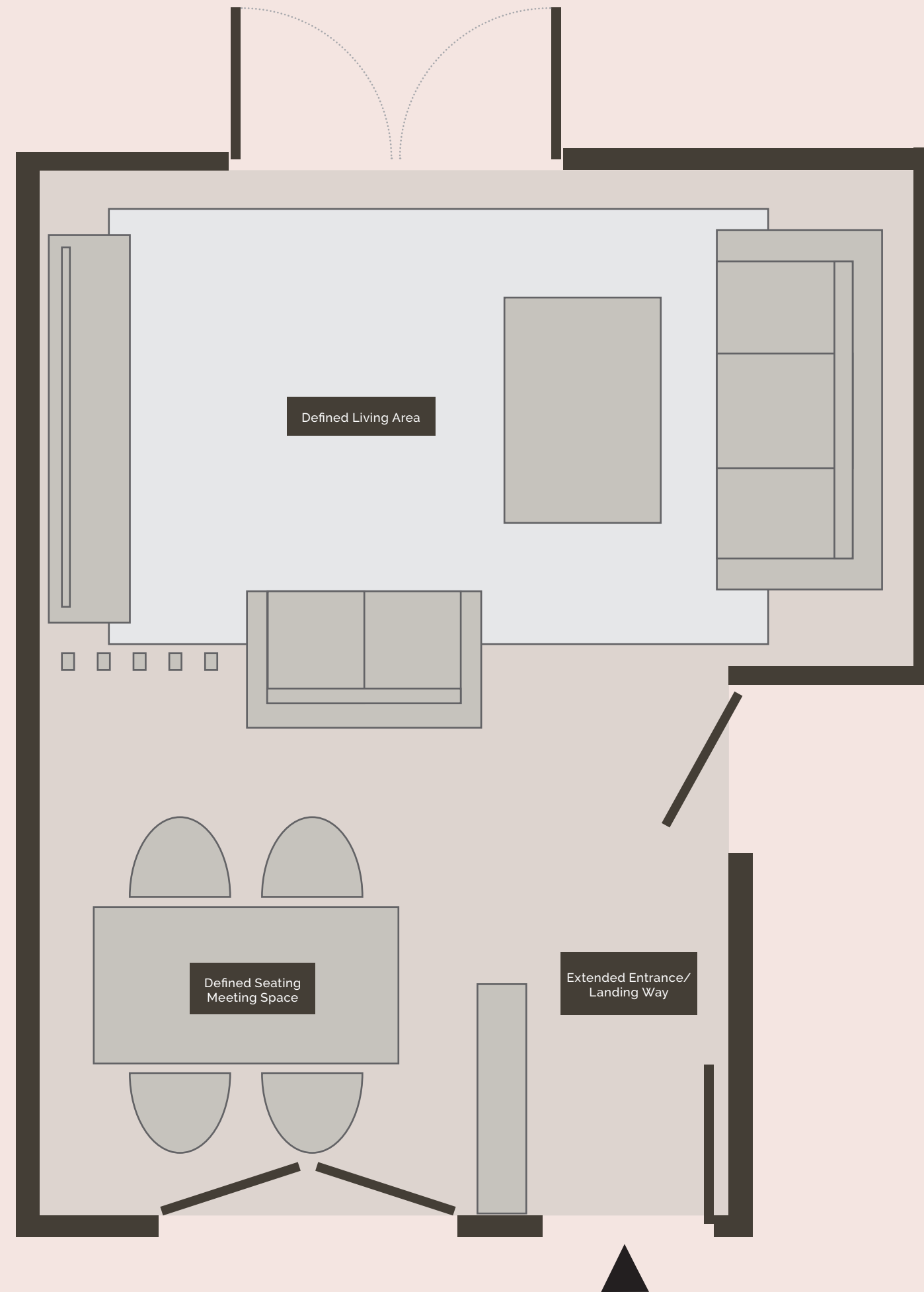

# Project Option 1

## Living Space Room Revamp

- Barn style sliding door installation to kitchen
- Built out TV console for recessed TV and electric/faux fireplace
- Feature slat wood wall and dining area
- Additional sofa to define space
- Flexible, less permanent space
- Decorative shelving in corner behind sofa
- Formal dining/meeting area
- Replacement of door to extension

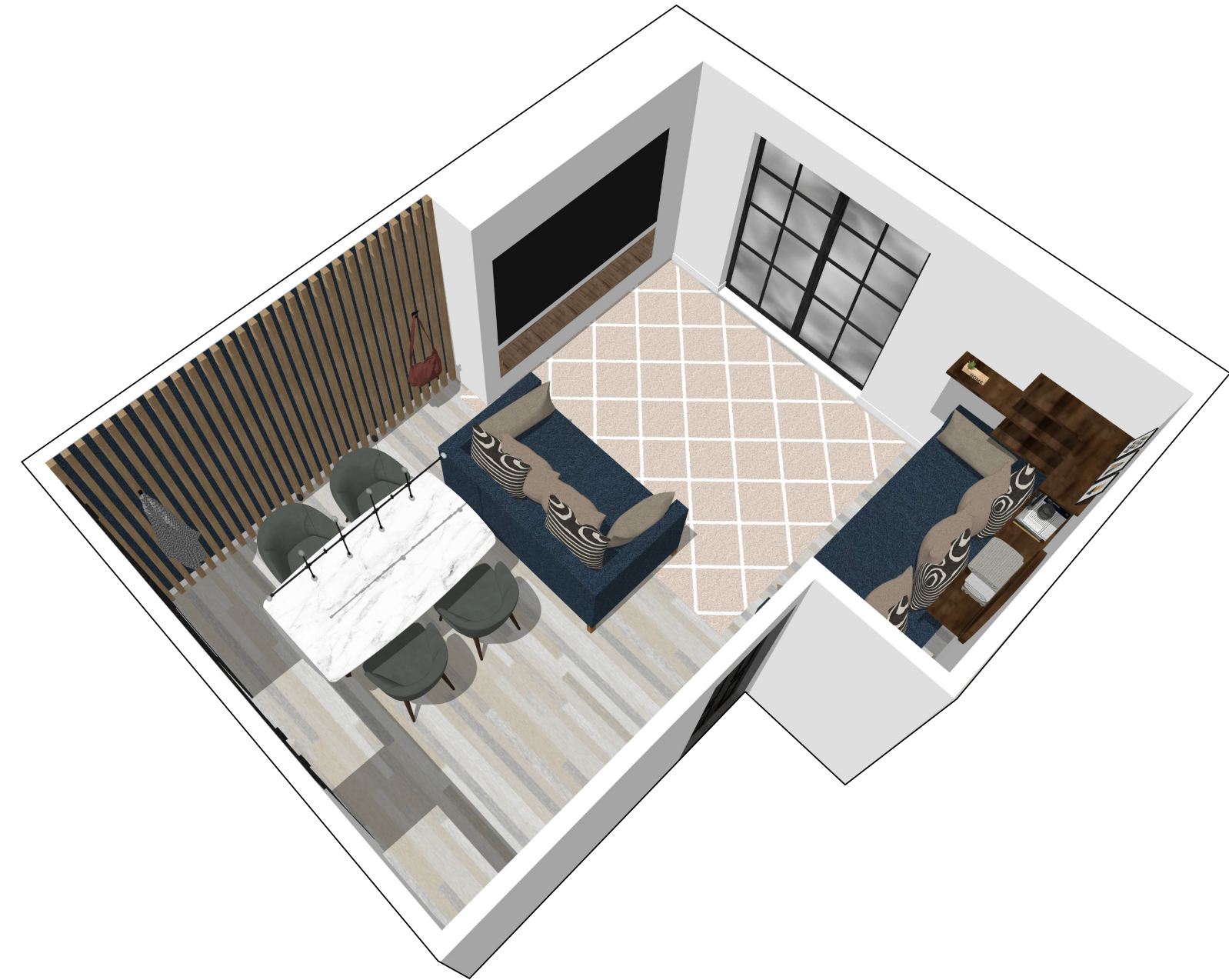
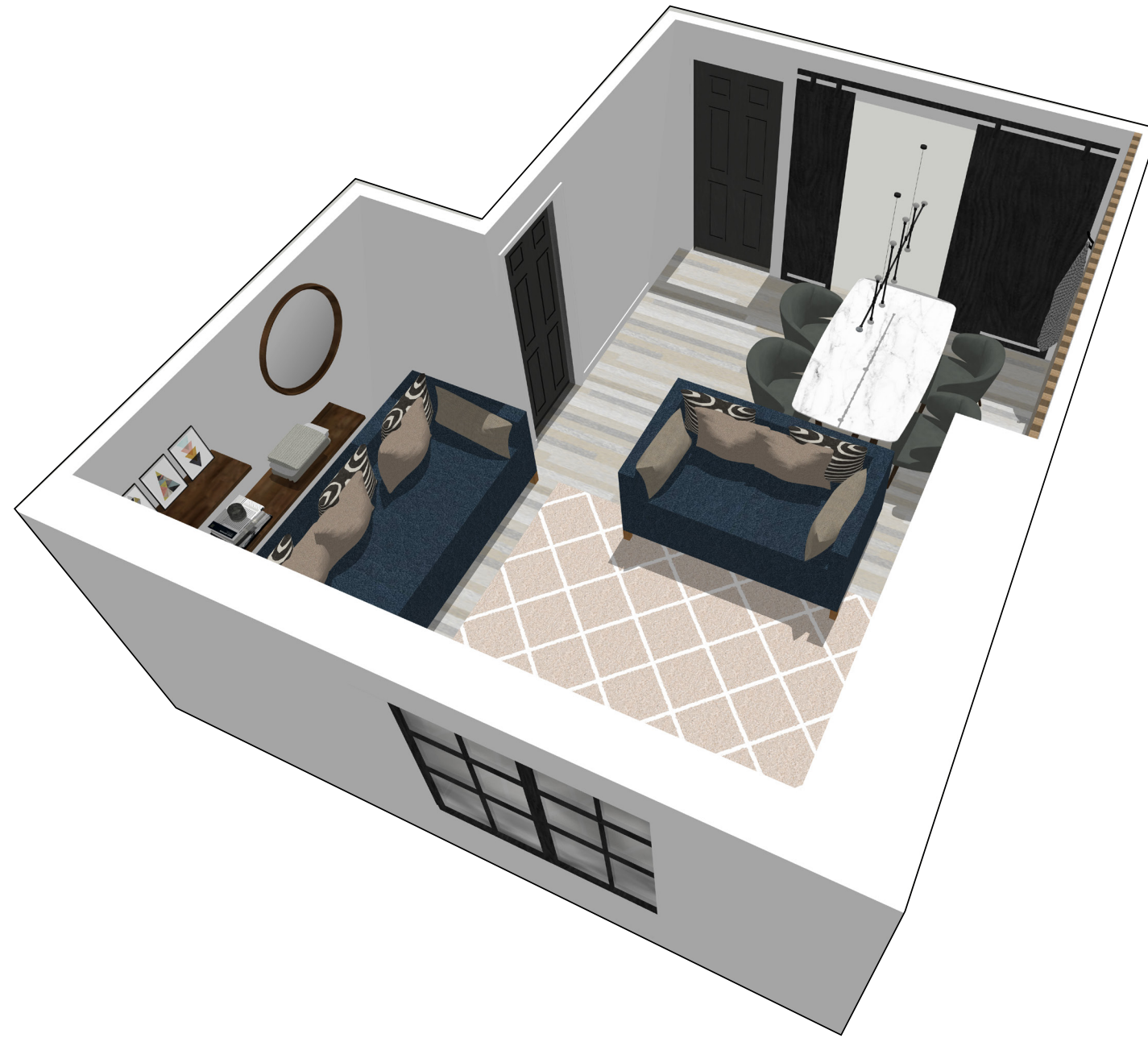

# Project Option 1

## Living Space Room Revamp

- Barn style sliding door installation to kitchen
- Built out TV console for recessed TV and electric/faux fireplace
- Feature slat wood wall and dining area
- Additional sofa to define space
- Flexible, less permanent space
- Decorative shelving in corner behind sofa
- Formal dining/meeting area
- Replacement of door to extension



# Project Option 2

## Living Space Room Revamp

- Minimal intervention and construction
- Built out TV console for recessed TV and electric/faux fireplace
- 2 feature walls with different language to distinguish spaces as opposed to larger furniture
- Open decorative shelving
- Flexible, less permanent space
- Addition of art pieces behind sofa



# Project Option 2

## Living Space Room Revamp

- Minimal intervention and construction
- Built out TV console for recessed TV and electric/faux fireplace
- 2 feature walls with different language to distinguish spaces as opposed to larger furniture
- Open decorative shelving
- Flexible, less permanent space
- Addition of art pieces behind sofa





# Project Option 3

## Living Space Room Revamp

- Main intervention involves semi-extension of kitchen through removal of full size door and use of an island unit
- Sliding window to open and close connection between living room space and kitchen
- Wooden slats to delineate seating space from lounge
- Allowance for larger living space with sofa, chairs and coffee table
- Option to exchange smaller chairs for full size sofa
- Standalone TV console unit underneath TV



# Project Option 3

## Living Space Room Revamp

- Main intervention involves semi-extension of kitchen through removal of full size door and use of an island unit
- Sliding window to open and close connection between living room space and kitchen
- Wooden slats to delineate seating space from lounge
- Allowance for larger living space with sofa, chairs and coffee table
- Option to exchange smaller chairs for full size sofa
- Standalone TV console unit underneath TV

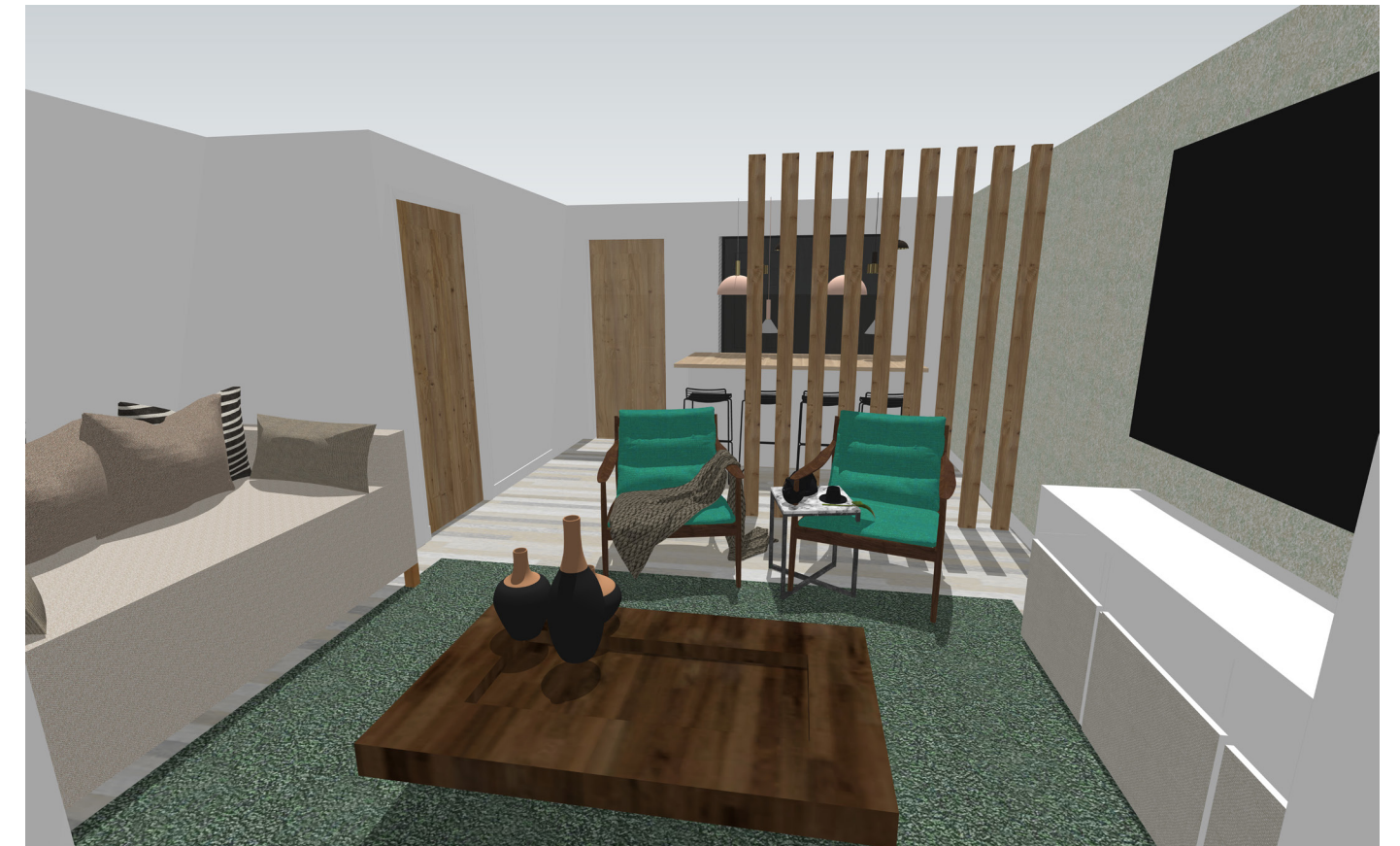

# Project Colour Palette

## Design Style [Complimentary]

- Monochromatic scheme utilises different shades of the same colour

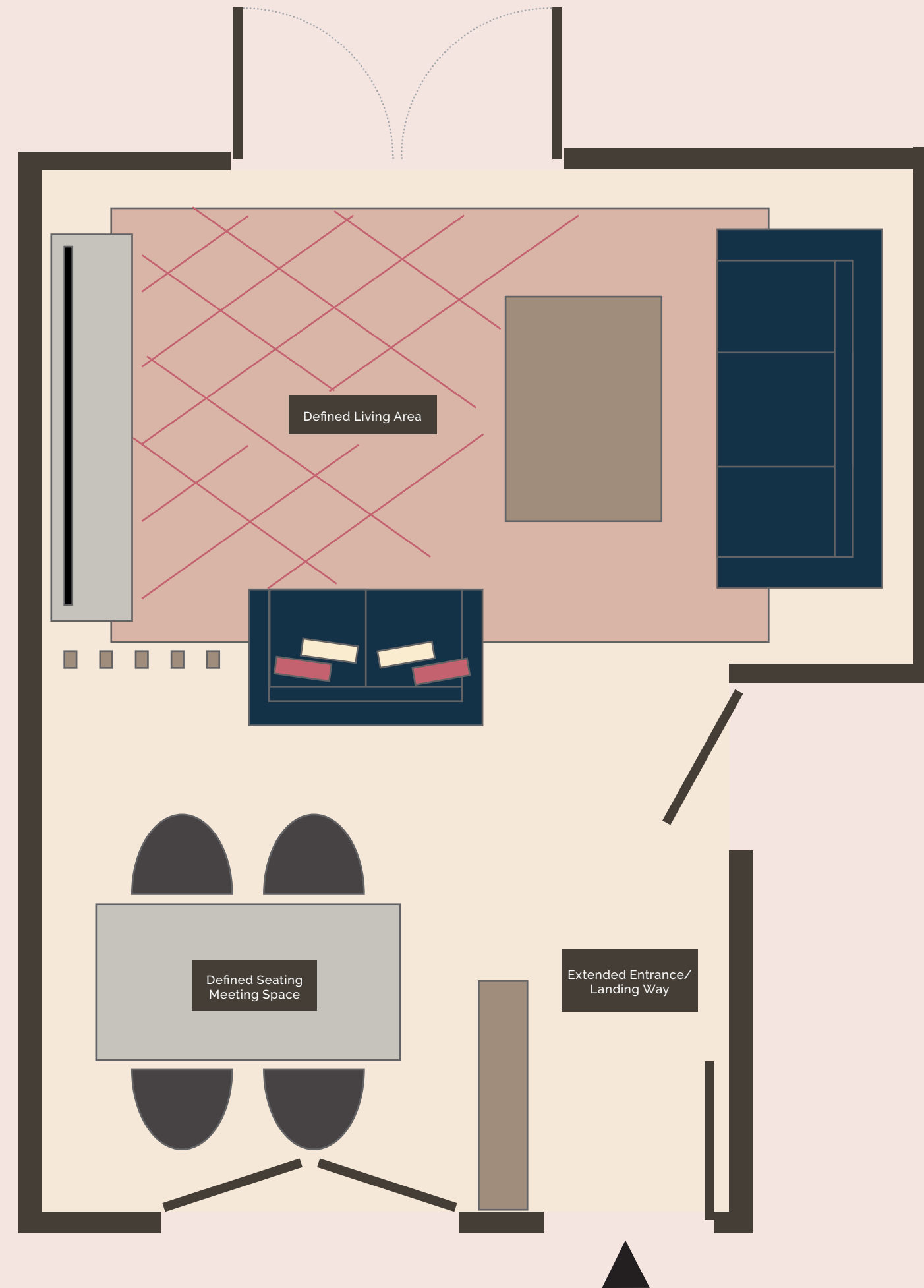

# Project Colour Palette

## Design Style [Complimentary]

- Overall monochromatic base colour scheme utilises different shades of the same colour iis complimented pops of colour filtered around the space.

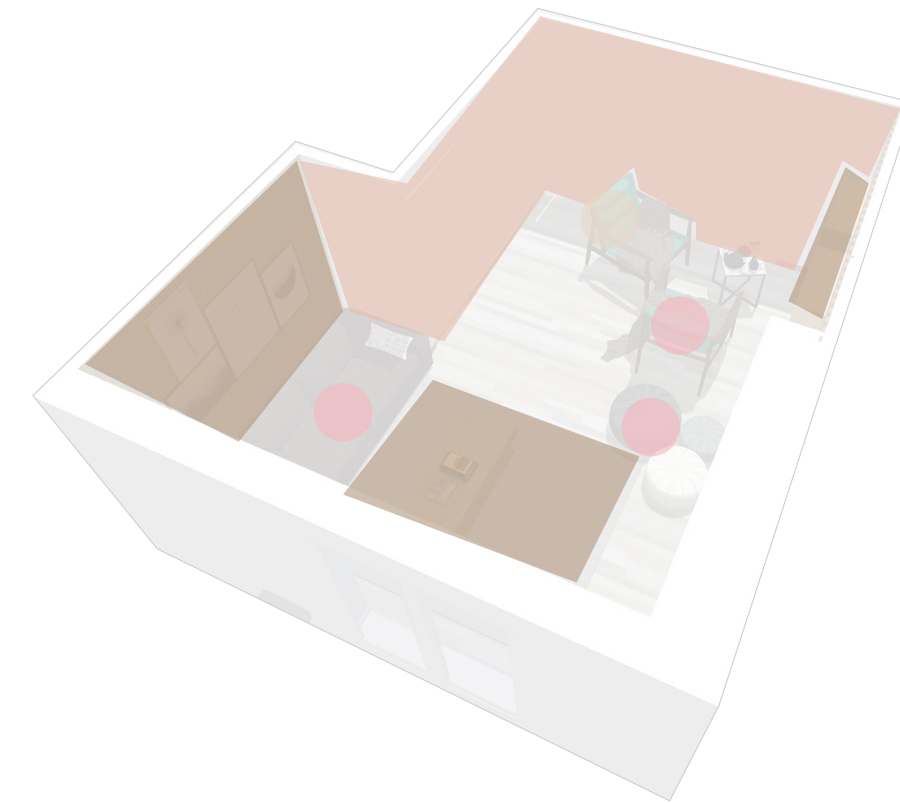
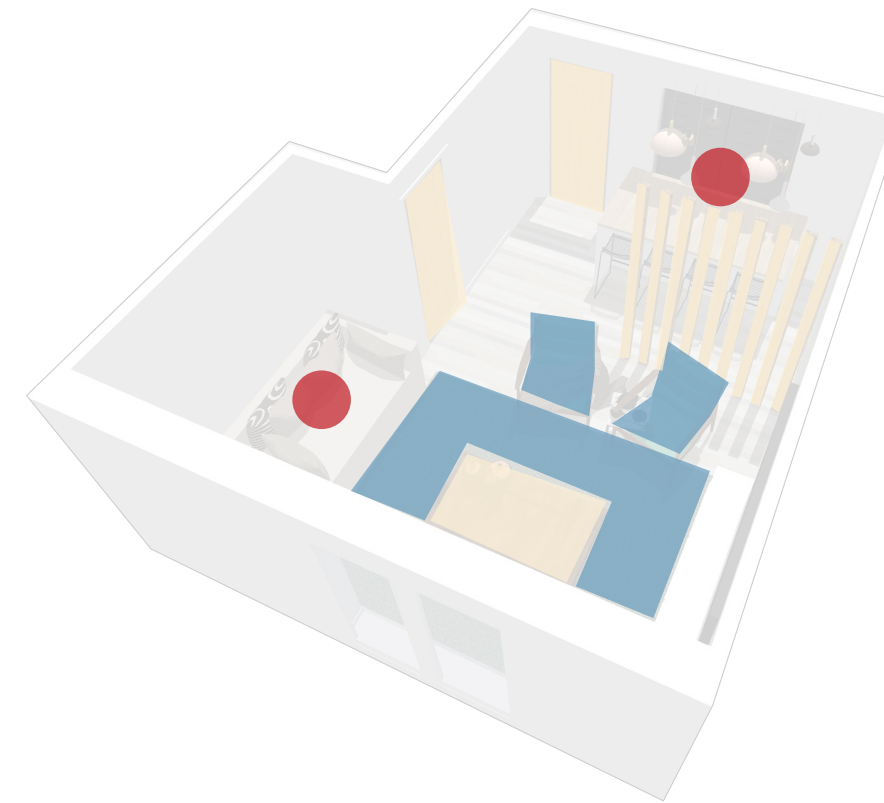
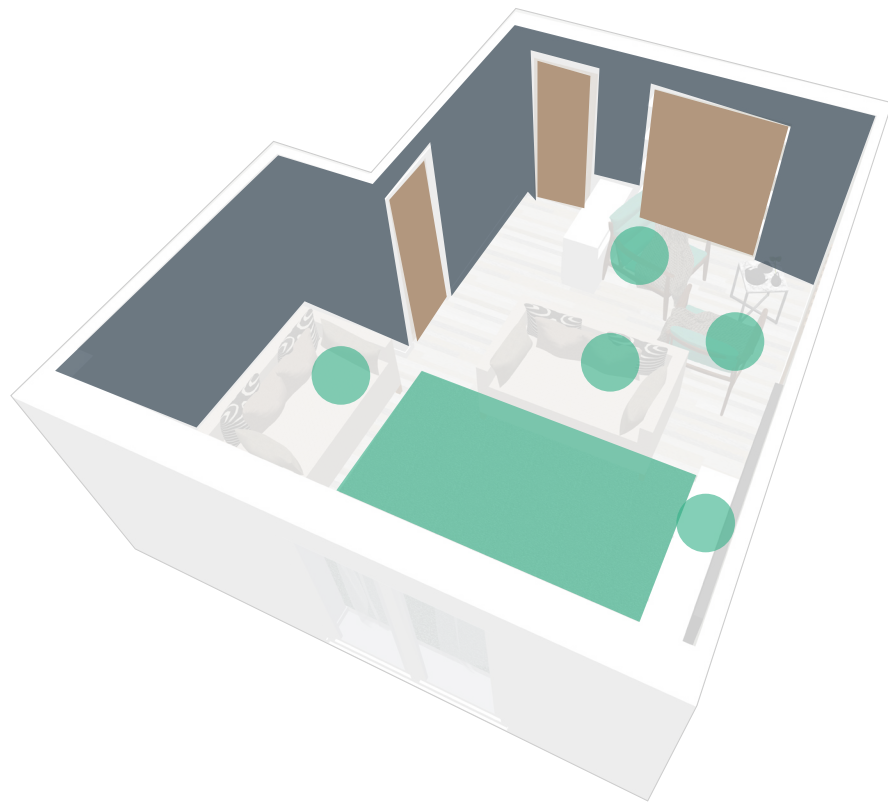
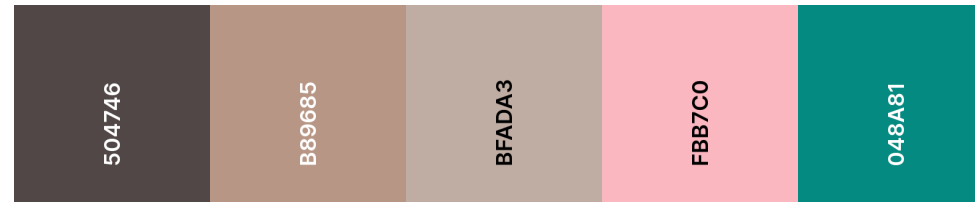
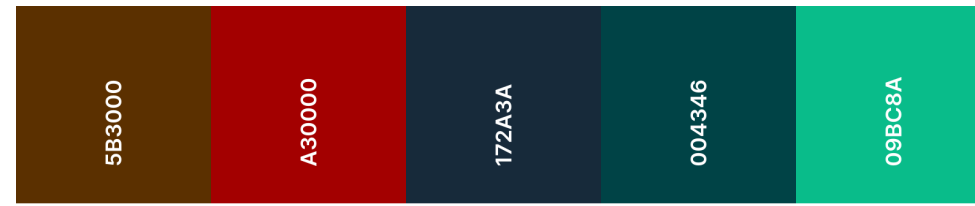

# Project Colour Palette

## Design Style [Monochromatic]

- Monochromatic scheme utilises different shades of the same colour
- Demonstration of how monochromatic scheme can be applied to each option

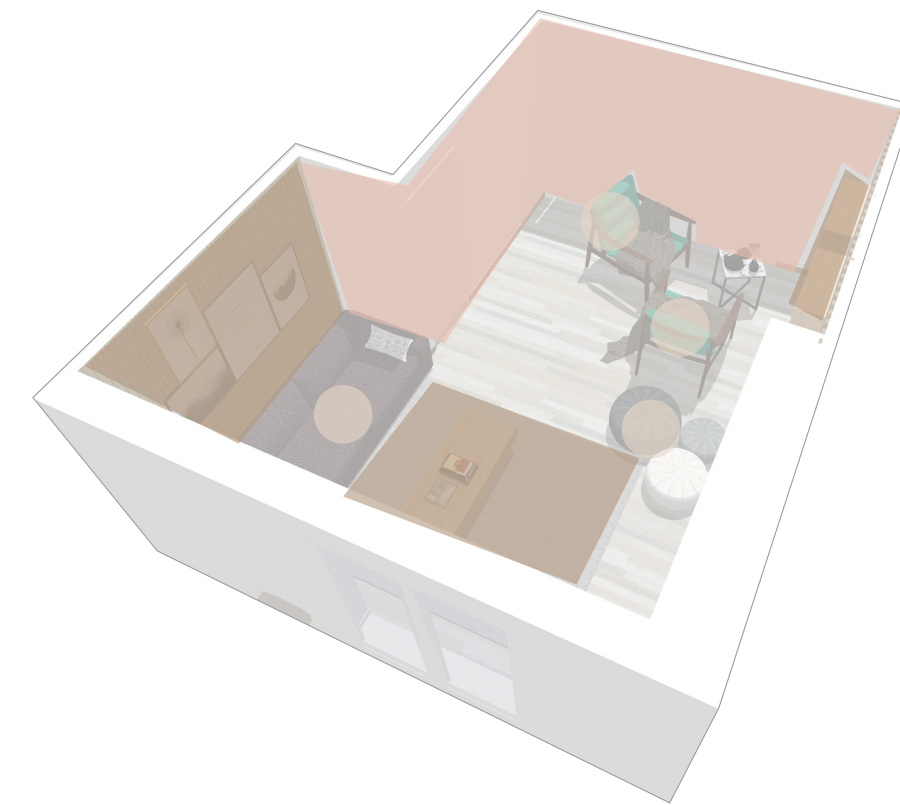
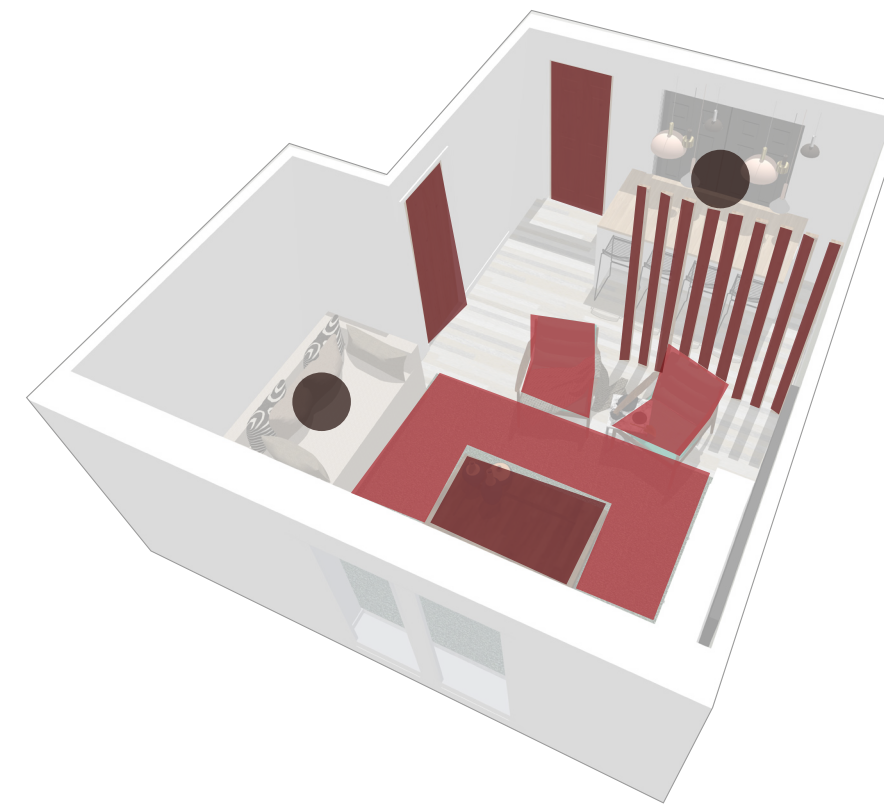
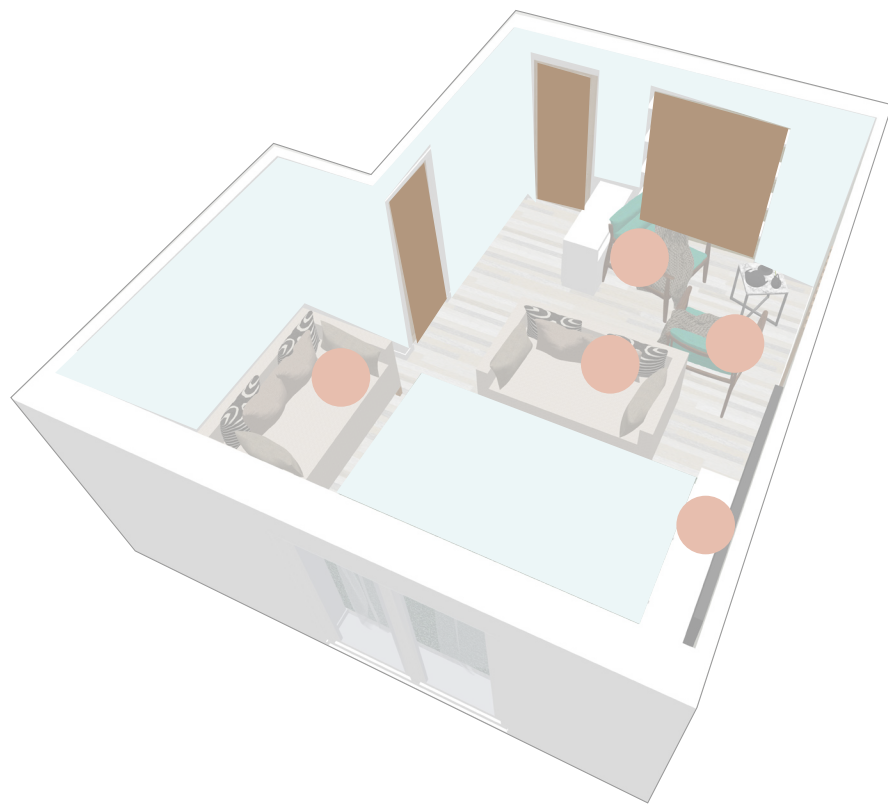

# Project Colour Palette

## Design Style [Analogic]

- Analogic scheme utilises multiple shades that are close to each other, can be mixed with a neutral
- Demonstration of how analogic scheme can be applied to each option

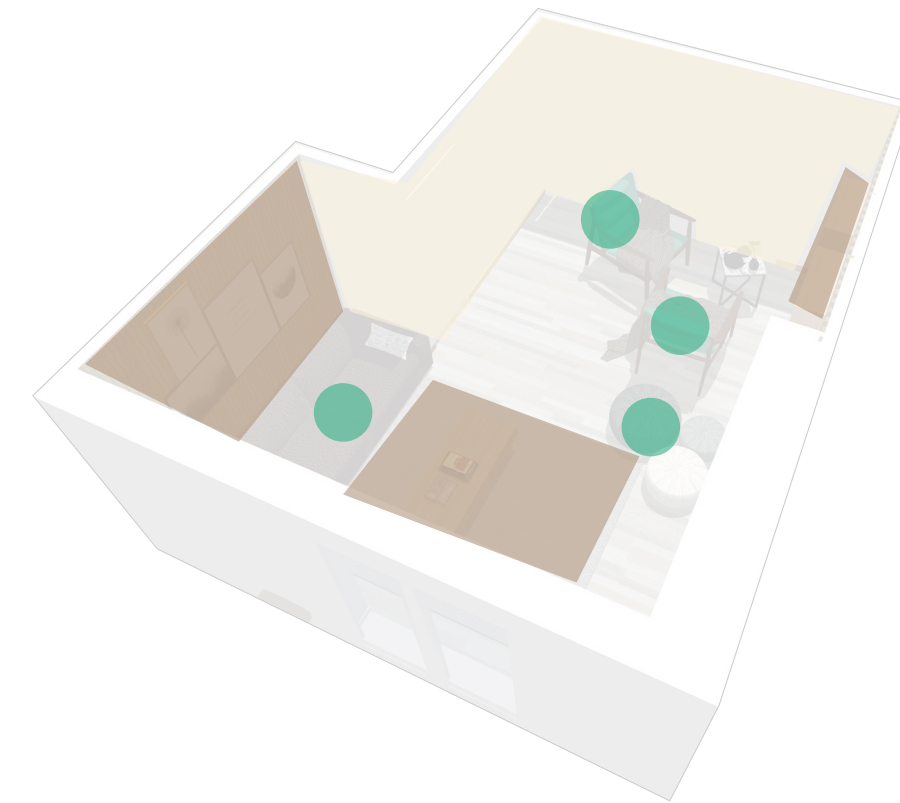
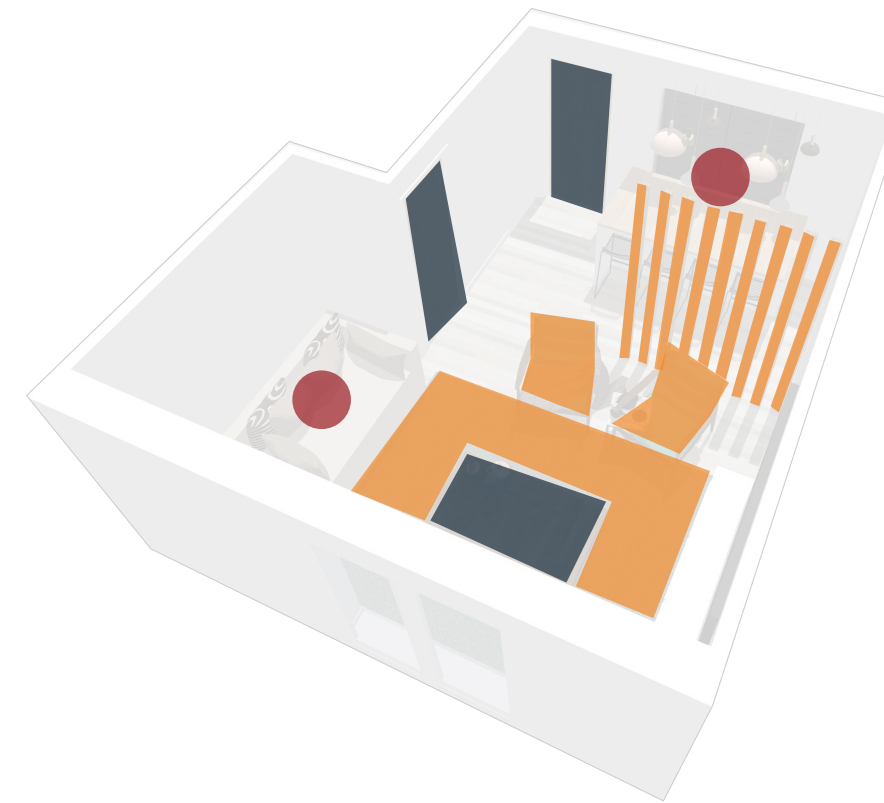
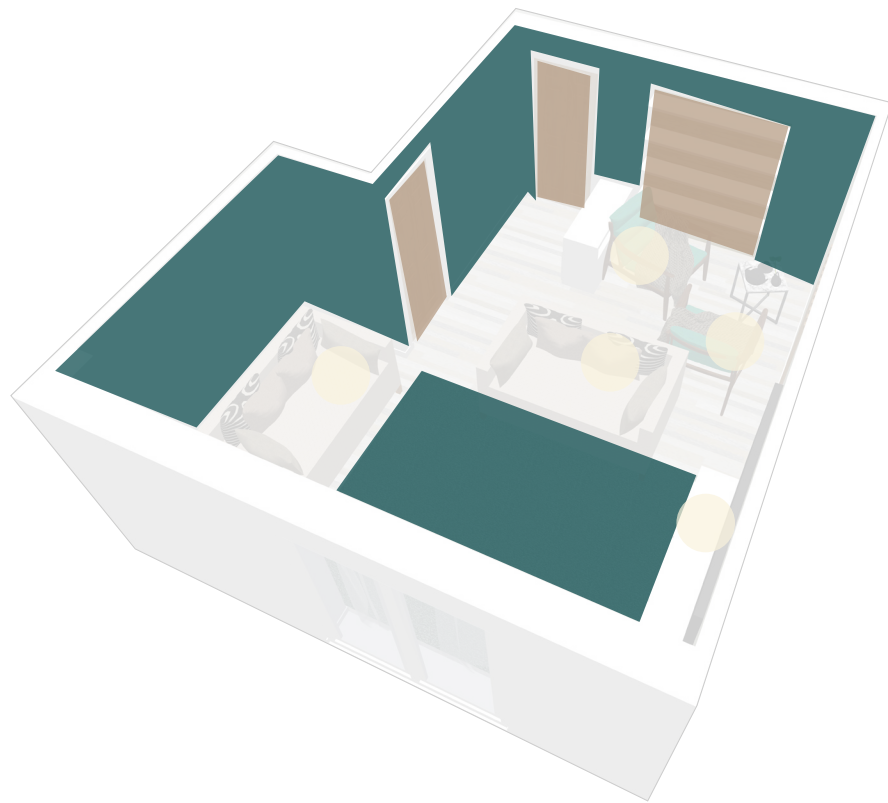
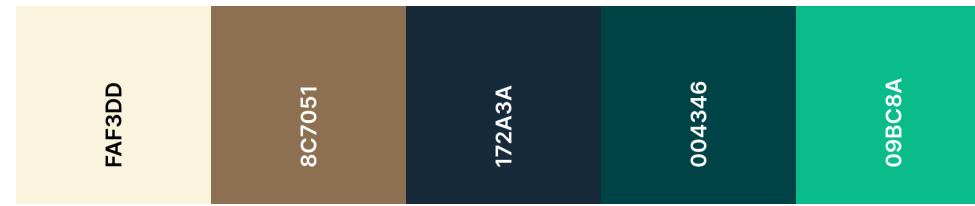

# Project - [Modern Minimalist] Moodboard



Use mirrors to reflect light in a small space



Lighting - Use warm lighting kelvin 2700 overhead with lots of smaller lamp sources around

Textures - Use soft textiles in curtains and cushions to soften the ambiance whilst maintaining the minimalist aesthetic



Incorporate wood panelling on walls, in furniture or as art pieces



Storage - utilised TV console, consider under sofa storage

Rug - Make sure the rug is large enough to get all furniture legs on. This will anchor the space



# Project Lighting

## Opportunities for secondary lighting

- Secondary light sources with warm bulbs will allow less use of overhead lights and provide more ambiance through less harsh lighting
- Hidden LED strip lighting behind TV fixtures
- Full standing floor lamp next to sofa
- Hanging pendant light over seating/ dining area
- Additional smaller light sources on decorative shelving
- Opening of curtains and kitchen slot for diffused for natural daylight
- LED spots implemented into skirting board

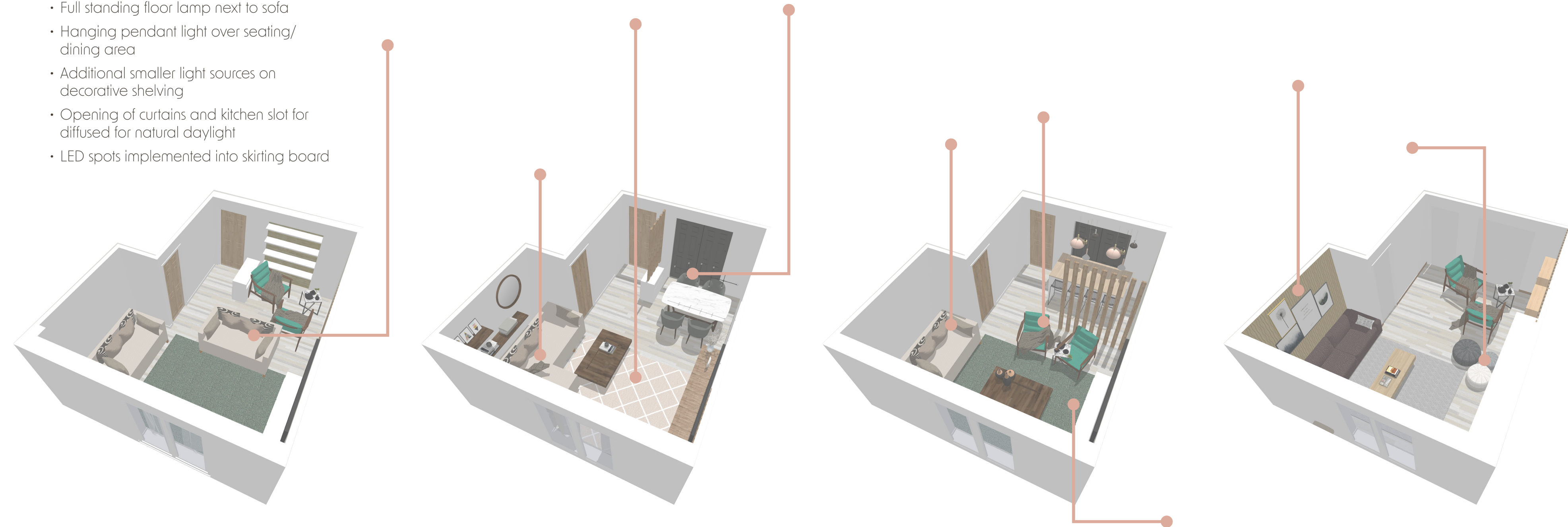



# Project Material Palette

- Monochromatic scheme utilises different shades of the same colour



Project  
3D Model



# Project Lighting

## Option 1

- 1 new sofa - 1000 - 3000 GBP
- Large Rug - 200 - 400 GBP
- Shelf units - 200 - 500 GBP
- Paint Samples - 30 GBP
- Paint Buckets - 100 - 150 GBP
- TV Console - 400 - 1500 GBP
- Cabinet/Entrance console - 150 - 250 GBP
- Free Standing Wooden Slats - 200 - 500 GBP
- Dining Table Set - 200 - 1000 GBP
- Coffee Table - 300 - 600 GBP
- Accessories; lighting, art, mirror and textiles - 200 - 500 GBP

Total Cost Estimate = 3000 - 8450 GBP

Does not include labour or bespoke item costs\*

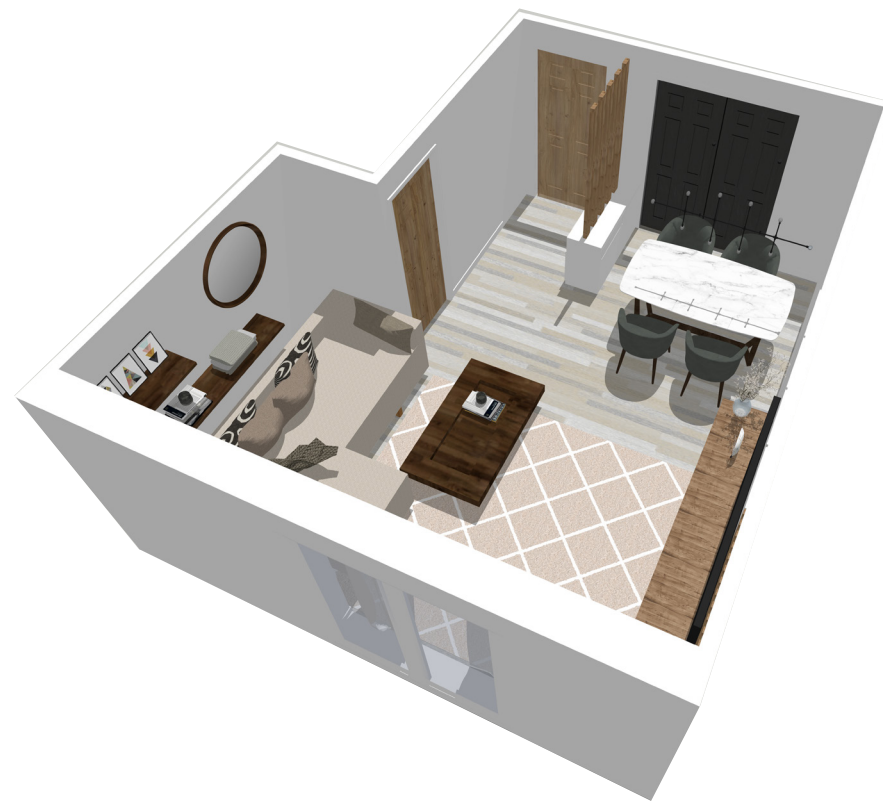

## Option 2

- 1 new sofa - 1000 - 3000 GBP
- Large Rug - 200 - 400 GBP
- New sliding doors for kitchen hatch 100 - 300 GBP
- Paint Samples - 30 GBP
- Paint Buckets - 100 - 150 GBP
- TV Console - 300 - 1500 GBP
- Kitchen island unit - 800 - 1800 GBP
- Free Standing Wooden Slats - 200 - 500 GBP
- 4 Bar stools - 200 - 1000 GBP
- Coffee Table - 300 - 600 GBP
- Pendant light for island - 100 - 400 GBP
- Accessories; lighting, art, mirror and textiles - 200 - 500 GBP

Total Cost Estimate = 3600 - 10400 GBP

Does not include labour or bespoke item costs\*

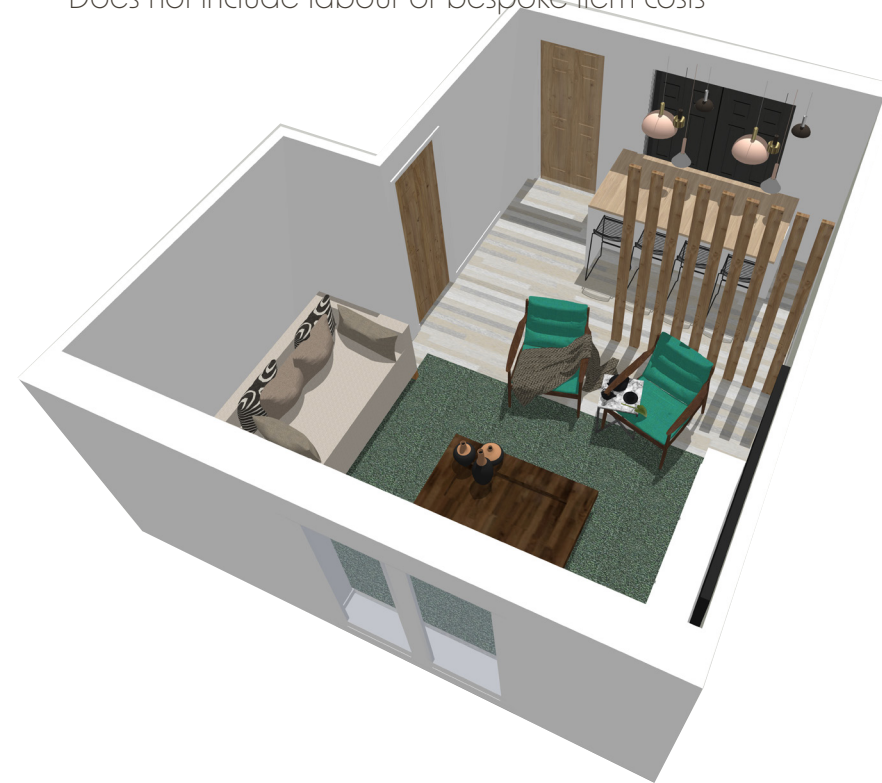

## Option 3

- 1 new sofa - 1000 - 3000 GBP
- Large Rug - 200 - 400 GBP
- Shelf units - 1000 - 3000 GBP
- Paint Samples - 30 GBP
- Paint Buckets/Wallpaper - 100 - 150 GBP
- TV Console with fireplace - 800 - 3000 GBP
- Coffee Table - 300 - 600 GBP
- Footstools - 200 - 900 GBP
- Accessories; lighting, art, mirror and textiles - 200 - 500 GBP
- Optional set of chairs - 200 - 1000 GBP

Total Cost Estimate = 4100 - 12600 GBP

Does not include labour or bespoke item costs\*

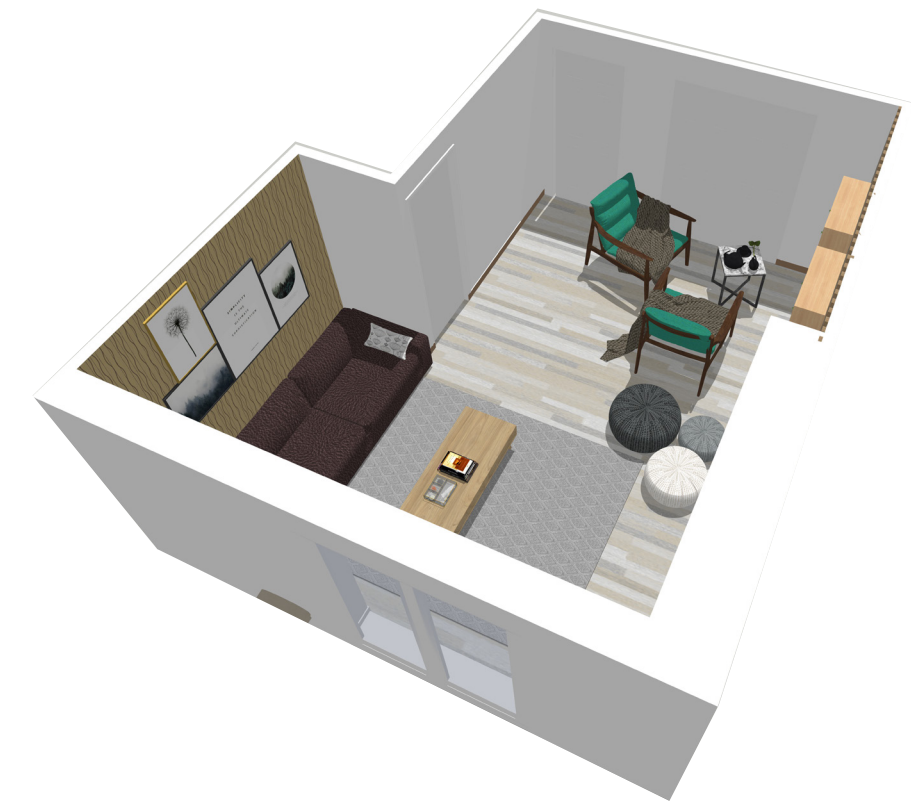

# Project

## Curated Shopping Links



### Pocket Friendly

- [furniturewebsite.com](#)
- [rugswebsite.com](#)
- [lightingswebsite.co.uk](#)
- [decorationswebsite.co.uk](#)
- [furniturewebsite.com](#)
- [rugswebsite.com](#)
- [lightingswebsite.co.uk](#)
- [decorationswebsite.co.uk](#)
- [furniturewebsite.com](#)
- [rugswebsite.com](#)
- [lightingswebsite.co.uk](#)
- [decorationswebsite.co.uk](#)



### Mid-Range

- [furniturewebsite.com](#)
- [rugswebsite.com](#)
- [lightingswebsite.co.uk](#)
- [decorationswebsite.co.uk](#)
- [furniturewebsite.com](#)
- [rugswebsite.com](#)
- [lightingswebsite.co.uk](#)
- [decorationswebsite.co.uk](#)
- [furniturewebsite.com](#)
- [rugswebsite.com](#)
- [lightingswebsite.co.uk](#)
- [decorationswebsite.co.uk](#)



### Premium

- [furniturewebsite.com](#)
- [rugswebsite.com](#)
- [lightingswebsite.co.uk](#)
- [decorationswebsite.co.uk](#)
- [furniturewebsite.com](#)
- [rugswebsite.com](#)
- [lightingswebsite.co.uk](#)
- [decorationswebsite.co.uk](#)
- [furniturewebsite.com](#)
- [rugswebsite.com](#)
- [lightingswebsite.co.uk](#)
- [decorationswebsite.co.uk](#)

Project Address

AKOKO Store Discount Code: XXXXXXXX

